

business
cube

[Book a tour](#)

55-56 Russell Square

Office Space Brochure



55-56 Russell Square, London, Wc1B 4HP

Overlooking the second largest square in Central London, our site at Russell Square is steeped in history and period charm. Standing in the square, it's hard not to be impressed – let some of this prestige rub off on your brand in our beautiful Grade II listed but high-tech building.

[Book a tour](#)

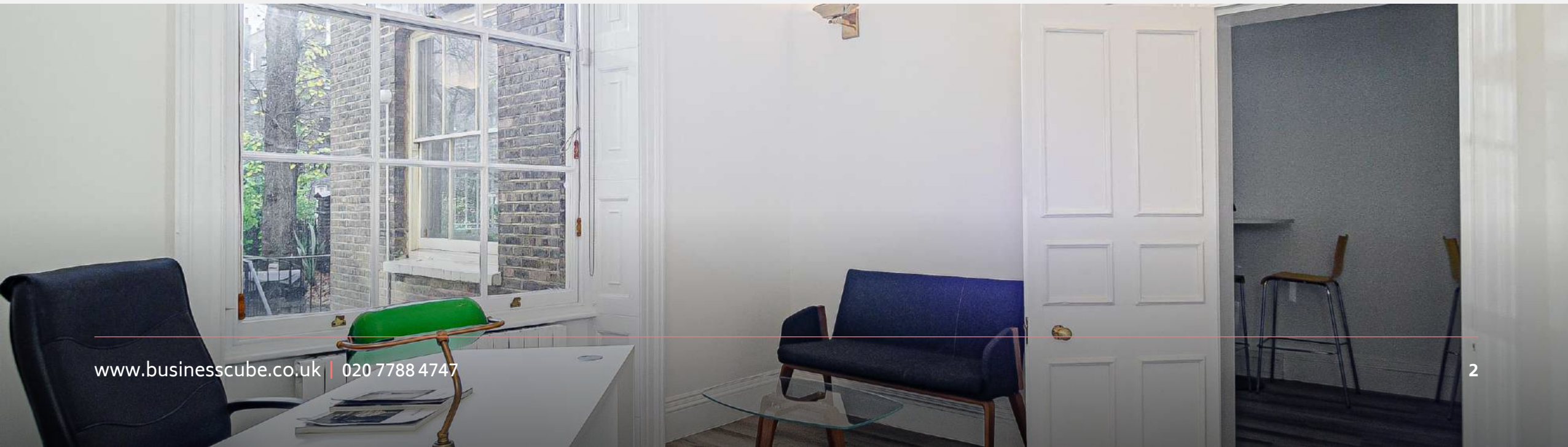



LOCATION

In a prime location on the southern side of the prestigious Russell Square Business Cube's fully refurbished Grade II listed office allows your company the opportunity to work in an inspirational environment full of history and period charm, whilst taking advantage of the latest technological and business amenities.

This fully serviced office space is within walking distance of Euston and Kings Cross, and is set over five refurbished floors complemented by a charming communal garden.



Inside 55-56 Russell Square















Inside 55-56 Russell Square





Key features

Facilities

- | | |
|---|---|
|  24 hour access |  CCTV |
|  Fully furnished |  Showers |
|  Bike storage |  Cleaning |
|  Manned reception |  High speed internet |
|  Communal garden area |  Waste collection |

Nearest Stations

Russell Square



Holborn



Kings Cross



The Business Centre is close to London Underground tube stations Russell Square and Holborn with Kings Cross and Euston also a short walk.

Nearest tube stations: Russell Square (Piccadilly Line), Holborn (Picadilly Line and Central Line) and Kings Cross (Circle, Hammersmith and City & Metropolitan, Northern, Picadilly, Victoria Lines and National Rail).

Rail: Thameslink



DEPOSIT:	2 months rent deposit + 1 months rent upfront
MINIMUM TERM:	24 months
INTERNET:	150mb dedicated bandwidth provided to cabinet
FURNISHED:	Fully furnished standard desks & chairs
FACILITIES:	Own kitchenette
RECEPTION:	Manned reception with call answering service
SERVICES:	Cleaning twice a day





[Click here to watch 2nd Floor, 55-56 Russell Square - Example Video](#)





Floor, Location, Size, Price

Ground Floor

1,690 sq ft
(self-contained)

£17,800 + VAT
pcm

Financials

START DATE:	TBC
TERM:	24 months
DEPOSIT:	2 months rent deposit + 1 months rent upfront
SET UP:	Office layout as it is, additional rooms or amendments will be charged on a non-profit basis, material & labour

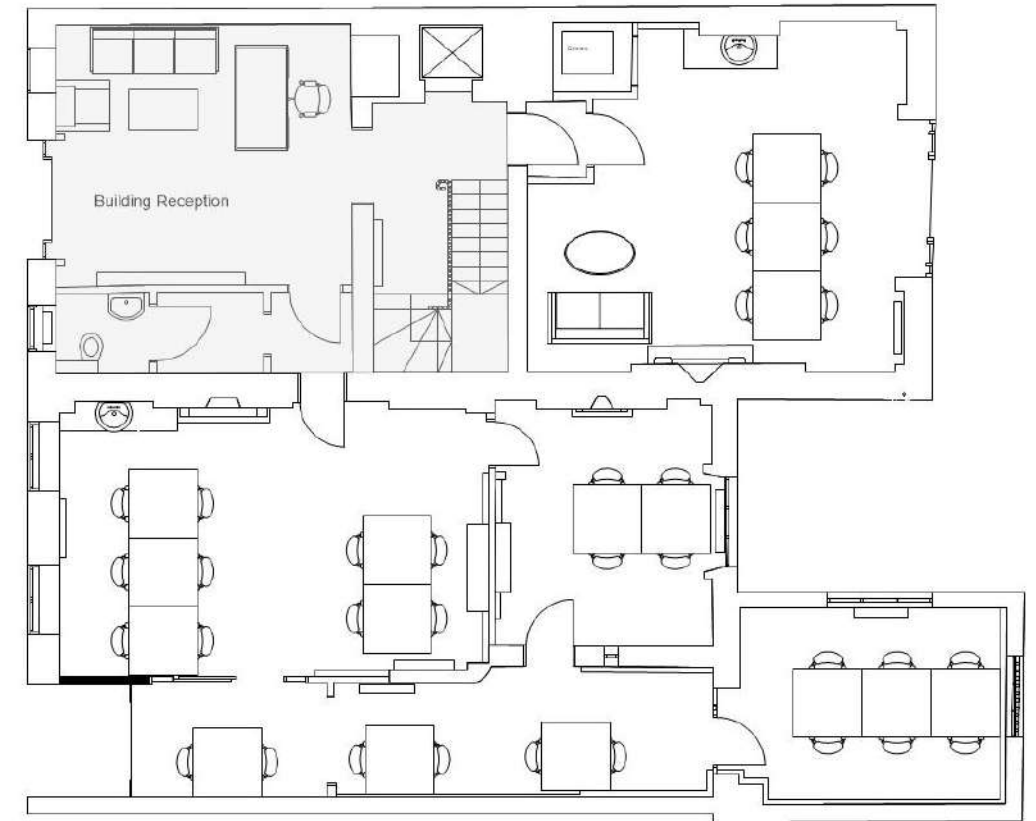

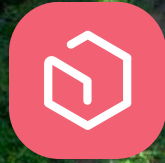

business
cube

Get in touch and we can discuss your requirements or arrange a viewing to show you around your dream office space

Call us: 020 7788 4747 | Email us: hello@businesscube.co.uk | www.businesscube.co.uk

Book a tour